



The CaRol Duratech 250 manual winch is designed to be installed in permanent facilities (ex: wall mounting) or for temporary tasks attached to a Tracpode<sup>(\*)</sup> using its console. The CaRol Duratech 250 winch is primarily used for lifting materials in various industrial environments. The device is designed to be used in situations where the winch body is exposed to mildly corrosive environments, and where the wire rope may be in the contact with aggressive or corrosive substances.

\* Information about our Tracpode and his console can be obtained upon request to Tractel or at [www.tractel.com](http://www.tractel.com).

## APPLICATIONS

- Chemical industry
- Sewage treatment plant
- Confined space
- Urban wastewater network
- Others

## TECHNICAL CHARACTERISTICS

- Compact and robust device
- W.L.L.\*\*: 250 kg
- Lifting height: 20 m
- Rigid frame and painted drum
- Stainless steel components:
  - Lifting wire rope
  - Swivel
  - Lifting hook
- Drum disengageable when empty by an easily accessible lever
- Double braking safety by self-locking wheel and screw system and use of pawl brake with double spring
- User and mechanical parts protections through a removable protective cover for maintenance
- Variable length control crank (6 positions)<sup>(1)</sup> allowing the user to adjust the effort or speed according to the load
- Option to remove the crank to disable its use
- Easily transportable thanks to its crossbar
- Designed and built to withstand dynamic test at 1.1 x W.L.L.\*\*, static test at 1.5 x W.L.L.\*\* and to guarantee minimum mechanical resistance of 4 x W.L.L.\*\*
- Equipped a QR code enabling product traceability and technical monitoring

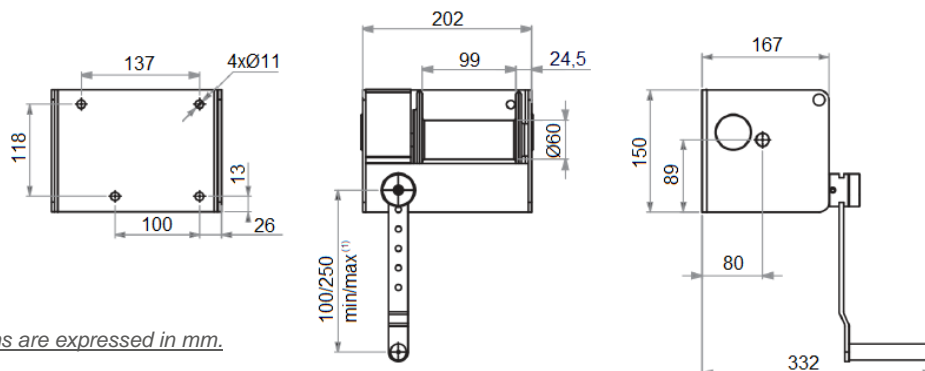

The dimensions are expressed in mm.

W.L.L.** (kg)	250
Lifting height (m)	20
Diameter wire rope (mm)	Ø5
Lifting distance per crank turn (mm)	19
Force on crank (daN) <sup>(2)</sup>	9

\*\* : W.L.L. = Working Load Limit

(1) : Per 30 mm increment

(2) : At last winding layer and maximum length of crank



## APPLICABLE STANDARDS

- European directive 2006/42/EC
  - UKCA Regulation
- Complies with all relevant provisions of the 2008 Supply of Machinery (Safety) Regulations (SI 2008/1597) as amended (SI 2011/1042, SI 2011/2157, SI 2019/696)

## PRODUCT CODE AND LOGISTIC INFORMATION

Code	Description	Code EAN	Net weight equipped (kg)	Weight (incl. packaging) (kg)	Packaging dimensions (mm)
299229	CaRoI Duratech 250	3600232992295	13.2	13.8	250x230x200